



12AM Stage Monitor



APPLICATIONS

Vocal Monitor
Instrument Reinforcement
Sound Stages

FEATURES

Two-Way Active
Max Output 131 dB SPL
LF Device: 12 in. (304.8mm)
HF Device: 2 in. (50.8mm)
Epoxy Mastic Finish
EP-4 Connectors (2 Male)

GENERAL DESCRIPTION

The Clair Brothers 12AM is the monitor of choice for the world's top entertainers. This portable, low-profile, high output stage monitoring speaker delivers incredible SPL, exceptional vocal reproduction, and unprecedented low frequency reproduction from a small enclosure. Designed for bi-amplification and custom processing (utilizing Clair Brothers amplification and processing), the 12AM is in a class by itself. No other product can duplicate its combination of performance, size and packaging.

The high frequency compression driver features a 2" throat diameter (4" voice coil diameter), a pure titanium diaphragm, and a neodymium magnet assembly. The driver is joined to proprietary asymmetrical horn for exceptional intelligibility. A custom 12" cone transducer provides mid-bass and low frequency reproduction. The combination of our professional high-output components deliver exceptional performance and unique directional characteristics.

Dual rear mounted EP-4 connectors (both male) allow the use of multiple cabinets from a single

amplifier. Low profile styling and flush mounted side handles provides great aesthetic appeal and portability. The speaker grille is constructed of high grade 14 gauge perforated steel and is specially treated to create a durable exterior finish.

Clair Brothers combines amplification, and proprietary DSP processing in portable racks for all monitor systems. Custom cabling for systems is available and can be pre-wired, labeled and delivered in road cases.

As with all Clair Brothers products, the cabinet is constructed of the finest Baltic birch and finished with a rugged exterior epoxy to withstand the most demanding conditions.

OPTIONS & ACCESSORIES

RC-12 – Road Case for (2) 12AM

Proprietary DSP + Amplification Rack Packages
Custom Colors Available

Call or e-mail Clair Brothers for more information on available options.
(717-665-4000) e-mail: sales@clairbrothers.com

I2AM Stage Monitor



AUDIO SPECIFICATIONS

Loudspeaker Type	Two-Way Active	
Frequency Response (+/- 2dB)	50Hz–18kHz	
Recommended Power Amplifier	1200W Peak @ 8 Ohms	
Sensitivity (1 Watt @ 1 Meter)	LF	102 dB SPL
	HF	111 dB SPL
Maximum Output	Peak	131 dB SPL
Drivers	LF	(1) 12 in. (304.8mm)
	HF	(1) 2 in. (50.8mm)
Nominal Impedance	LF	8 Ohms
	HF	16 Ohms
Power Handling	LF	300W Cont.
	HF	150W Cont.
Dispersion	Proprietary Asymmetrical	
Input Connections	Standard	(2) EP-4 Connectors (2 Male)

MECHANICAL SPECIFICATIONS

Enclosure	Shell	18mm Baltic Birch
	Finish	Black Epoxy Mastic
Grille	Perforated Steel, Foam Backed	
Dimensions	Height	13.94 in. (354.0mm)
	Width	22.43 in. (569.7mm)
	Depth	18.00 in. (457.2mm)
Weight	68 lbs. (30.8kg)	
Shipping Weight	76 lbs. (34.5kg)	

Note: All wattage figures are calculated using the rated nominal impedance.

Clair Brothers products are designed to perform optimally by utilizing factory recommended proprietary DSP settings.

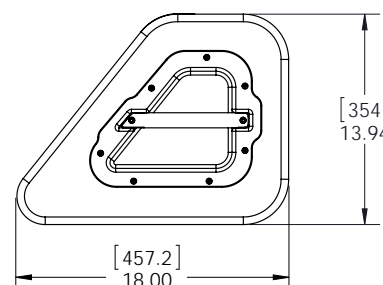
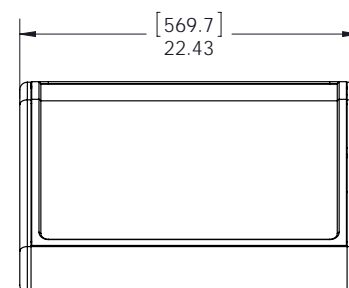
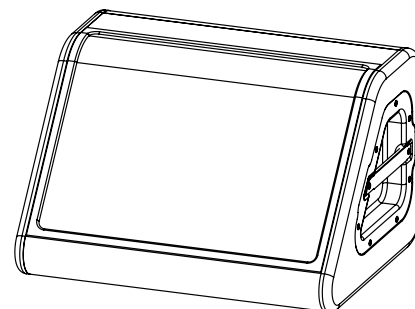

12AM EP-4 Pin Configuration

Pin	Use
1	Low (-)
2	Low (+)
3	High (-)
4	High (+)

ARCHITECT AND ENGINEER SPECIFICATIONS

The loudspeaker shall be a two-way active system featuring a total of two drivers. The low frequency module contains one 12 in. driver capable of handling 300 watts of pink noise with a 6 dB crest factor for 8 hours (as per EIA RS-426-A standard). The high frequency model contains a 2 in. exit, 4 in. voice coil diameter compression driver joined to a proprietary asymmetrical horn. The 2 in. driver is capable of handling 150 watts (1 kHz to 10 kHz) of pink noise with a 6 dB crest factor for two hours (as per AES-1984 and ANSI S4.26-1984 standards). The signal processing is Clair Brothers proprietary data. The enclosure shall be constructed of 18mm, 13-ply Baltic birch and covered with a durable black epoxy mastic finish. The dimensions shall be 13.94 in. high, 22.43 in. wide, and 18.00 in. deep. The system weight shall be 68 lbs. (30.8kg). The loudspeaker shall be the Clair Brothers 12AM.

CLAIR BROTHERS • ONE CLAIR BOULEVARD • MANHEIM, PA 17545 • 717-665-4000 • WWW.CLAIRBROTHERS.COM

CBAS20140827

Due to constant research, development and improvements all specifications are subject to change without notice.

